



**Gujarat Cooperative Milk Marketing Federation Ltd, Anand
AmulFed Dairy (Previously known as AmulFed Dairy)**

Plot No. 35, Nr. Indira Bridge,
Ahmedabad-Gandhinagar Highway
Village: Bhat, Dist: Gandhinagar
Gujarat, India-382428

Request for Bid (RFB) for “**Purchase Inquiry for Supply, installation and commissioning of Clean Room Partition for New GC (NABL) Lab**”as per given scope of work.

AFD: PUR: ENQ: 2021: 485





AMULFED DAIRY

(A Unit of Gujarat Co-operative Milk Marketing Limited)
Plot No. 35, Near Indira Bridge, Ahmedabad-Gandhinagar Highway
Village - Bhat, Dist - Gandhinagar - 382428
Phone : +91-79-3969055/56 Fax : +91-79-3969059

We invite sealed bids from eligible bidders for the following works: "**Purchase Inquiry for Supply, installation and commissioning of Clean Room Partition for New GC (NABL) Lab**" as per the scope of supply mentioned in the Inquiry.

Bid Reference	AFD: PUR: ENQ: 2021: 485
Bid Start	Starts from 2.07.2021
Submission	Up to 02.00 pm of 16.07.2021
Completion period	3 months
EMD (Rs. in Lac)	2.00

Eligibility Criteria

- 1) Bidder should be having minimum 5 numbers of successful installations of similar nature (Clean room for Laboratory and other similar process) working in India.
- 2) The Bidder/Supplier shall have turnover, in each of the last three years, at least Rs. 2 Cr and must have executed, in the last five years at least a contract of similar nature and of value not less Rs. 50 Lac

Technical Specification : As per the Annexure-I

Bid Security:

1. All bids must be accompanied by bid security (Earnest Money Deposit – EMD) in the form DD or RTGS/Fund Transfer. The bids not accompanied with EMD shall be summarily rejected. The bid security shall be denominated in Indian Rupees of value as specified and shall be in the form of Demand draft or RTGS/Fund Transfer to below specified account in favor of AmulFed Dairy (A unit of GCMMF Ltd), payable at Ahmedabad.

The Bid security may be forfeited if

- ❖ A bidder or supplier withdraw its bid during the period of bid validity specified by the bidder/ supplier on the bid form or
- ❖ In case of successful bidder/ supplier, if the bidder/ supplier fails to sign the contract.

2. Bank Detail for RTGS:

AmulFed Dairy, Gandhinagar (A unit of GCMMF Ltd)

HDFC Bank A/c. No: A/c. No. **00060310001593**

Branch Code: 0006 (NAVRANGPURA BRANCH)

Bank AD Code : 0510007-5700009

Swift code : HDFCINBB

IFSC Code : HDFC0000006

Submission of Bid :

Bidders fulfilling above eligibility criteria eligible for submission of bids in their name only.

- 1.1 The bid shall be submitted through hardcopy before above due date is acceptable.
- 1.2 The Price Break up sheet (in separate sealed Envelope) and technical document shall be submitted at the office address mentioned below.
- 1.3 The price Break up sheet should be entitled with reference of "Price Break Up for, **Purchase Inquiry for Supply, installation and commissioning of Clean Room Partition for New GC (NABL) Lab**".

Rights Reserved by AmulFed Dairy (A unit of GCMMF Ltd).

AmulFed Dairy (A unit of GCMMLtd), at its sole discretion and without assigning any reason thereof, reserves the right to accept and / or reject the whole or part of any or all the bids received.

Validity :

The offer should be valid for 6 Months from the date of Bid opening.

Contact details: For any techno-commercial query you may contact Palak Shah (7359001666), or (E-mail-palak.shah@amul.coop) of Purchase department.

Technical Specification & Scope of Supply

Sr No	Item Description	Unit	Qty
1	Non-Progressive Type Modular Partition System Aluminium Modular Double Skin Flush Partition 60mm thick with using 1.2mm Thk sheet finished with powder coated & PUF Insulation. (Suuply & installation)	SQ.Ft	5065
2	Non-Progressive Type Modular Partition System Aluminium Modular Double Skin Flush Partition 60mm thick with using 1.2mm Thk sheet finished with powder coated & PUF Insulation. (Supply & Installation)	SQ.Ft	5065
3	Providing of aluminium Powder Coated Flush Door 49 mm thick with using 1.2mm thk. Alu.sheet 4mm Plain glass flush on both sides fixed with 3M / saint gobin adhesive tape with Puff insulation. The Frame Work of Door Shall Be fabricated from 90 x 45 x 2 mm Thk. aluminium sections, * The Door frame Size Shall be 60 x 53 x 2.75 mm Thk. WITH Dorma Make Door Closer , Handle , lock and Autodrop seal for door bottom . Size of the Door 900mmx2100mm	No	18.00
4	Providing and Fixing of SS Mat Finish Handle 450 MM Height (D Type)	Nos	18.00
5	Providing and Fixing of Door Closure (Dorma Make)	Nos	18.00
6	Providing and Fixing of Door Lock (Dorset Make)	Nos	18.00
7	Providing and Fixing of Autodrop Seal for Door Bottom	Nos	18.00
8	Non-Progressive Type Modular Ceiling with Flush Partition 60mm thick with using 1.2mm Thk sheet finished with powder coated & PUF Insulation.	SQ.Ft	5065
9	Modular 3D Coving (Top & Bottom)	R.Ft	1900
10	SS Kick Plate	nos	36
11	Cladding work	Lumpsum	
12	Electrical Lighting And Wiring (22 W) Approved Make: Havells, Syska, Wipro Cable: Polycab, RR, KEI, Finolex	Nos.	100
13	Switch Board for Lighting Approved Make: Legrand or equivalent	Nos.	25

***Final Payment would be made against Joint Measurement Sheet.**

Payment term for the Inquiry:

Payment for supply, installation and commissioning contracts must be strictly as below:

- 1) 20% advance of total contract value (Supply + Erection & Commissioning) on submission of following:
 - (i) Acceptance of the order i.e.
 - a. Submission of the Duplicate copy of the order duly signed by the authorised signatory putting stamp of the Organisation.
 - b. Against a bank guarantee for equivalent amount valid for 60 days beyond the stipulated delivery (as per schedule of delivery/supply)/ completion period.
- 2) Payment against Supply and erection of equipments/material:
 - a. 65% progressive payment of supply value against safe receipt of goods at site.
 - b. 65 % payable on erection value on progression of erection within 30 days.
- 3) 15% balance payment within 30 days of satisfactory commissioning of the Tanks. On submission of:
 1. The Performance Security shall be in the amount of 15% of the Contract price up to sixty days after the date of completion of performance obligations including warranty obligations.

Notes: a) Payment shall be made on complete supply of an item/group of items specified in the contract. No payment specified in the contract. No payment shall be made if supply of an item/group of items is incomplete.

b) For all the payments to be made against bank guarantees, The Bank Guarantees should be obtained from Nationalized Bank or ICICI Bank, HDFC Bank, IDBI Bank, Kotak Mahindra Bank or acceptable Bank by AFD.

Liquidated Damages

Bidder/Supplier fails to deliver any or all of the Goods or perform the Services within the time period(s) specified in the Contract, the Purchaser shall, without prejudice to its other remedies under the Contract, deduct from the Contract Price, as liquidated damages as under:

a. For the Supply Component:

A sum equivalent to **0.5%** of the delivered price of the delayed goods (As per the price break up furnished by the supplier and accepted by the Purchaser, which the supplier fails to supply within the time period specified in the contract for each week of delay.

b. For the Erection and Commissioning Component:

A sum equivalent to **0.5%** of the un – executed portion of each week of delay or part thereof beyond the time specified in the contract for the successful completion of the plant.

The total amount so deducted as per above, shall not exceed **5%** of the Contract value. Once the maximum is reached, the Purchaser may consider termination of the Contract.

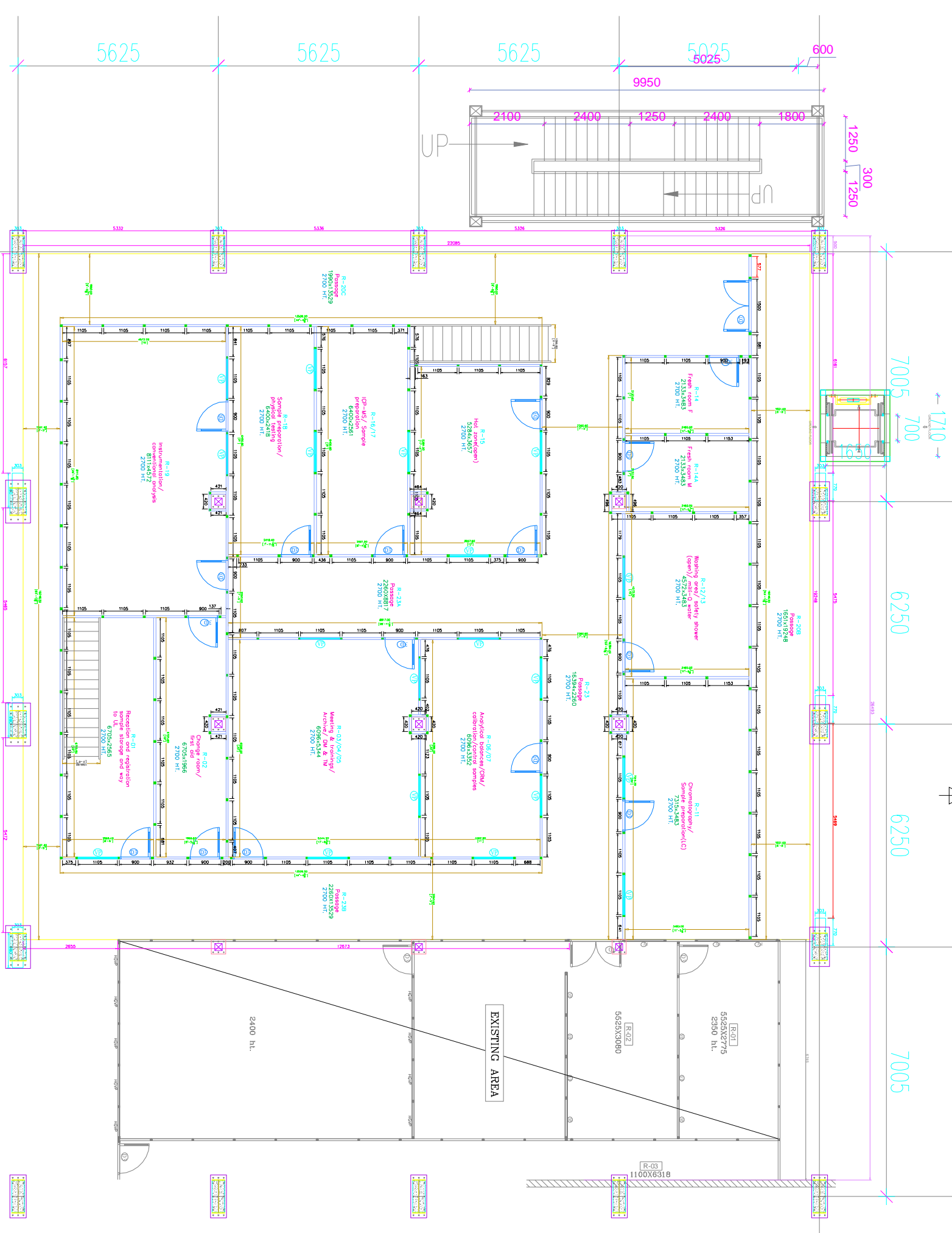

Lower level
 GCMMF
 QC-Laboratory
 Gandhinagar

Legends :- Door Height- 2100mm Partition Height- 2700mm	Client : AmulFruid Dairy Project : NABL LAB
Powder Coating:- Partition :- Door:- Door vp dam-	Title : AuL Flush Door & Flush Partition & walk-on-ceiling 60 mm thk. Project No : NP Drawing No. : A/P/00/20-21
Designed By :	Checked By :
File Ref. : C:\User\ASHWIN PATEL\Desktop\Amul Dairy Gandhinagar R-05.dwg	Approved By :
	Date : 25.06.2021

QUALIFICATION APPLICATION

Qualification Application Form

You must submit this form (Table 2 and 3), duly filled in, along with the supporting as per following checklist given in Table 1:

Table 1 Checklist for Supportings	
<i>Supportings Required</i>	<i>Please (√)</i>
Latest Balance sheet filed with (Name of Authority) on (Date)	
Latest Profit & Loss Statement from (date) to (date) filed with (Name of Authority) on (date).	
Audited copies ¹ of annual accounts and P & L account of past 3 years	
Certificate of Financial Soundness from Bankers of Bidder/Suppliers	
Income Tax Clearance Certificate (Latest)	
Sales Tax Clearance Certificate (Latest)	
Details of Income Tax Registration	
Details of Sales Tax Registration	
Organization Chart	
Annual Report of last three years	

¹ Indigenous Bidder/Suppliers must attach copy of accounts audited under section **44 AB of Income Tax Act**. In case the accounts need not be audited, a Chartered Accountant or Manager of a Nationalized Bank should attest the information in this statement.

**Table 2
Financial Soundness**

General Information			
Name			
Address			
Phones			
Mobile			
Fax			
E-mail			
Contact Personnel with designation			
Financial Information			
S N	Description	Value (Rs)	
1	Cash Balance	In Bank	
		In Hand	
		Total	
2	Fixed Assets	Gross	
		Net	
3	Current Assets	Inventories	
		Others	
		Total	
4	Current liabilities	Bank Cash Credit	
		Sundry creditors	
		Others	
		Provisions	
		Contingent Liabilities (including claims not acknowledged, please specify)	
		Total	
5	Capital	Share capital	
		Free reserves	
		Other reserves (please specify)	
6	Term loans from financial institutions and banks		
7	Working capital		
8	Net worth		

9	Debtors and advances considered good	More than 6 months	
		Less than 6 months	

Significant Financial Ratios			
SN	Ratio	Definition	Value
1	Current	Current Assets to Current Liabilities	
2	Acid Test	(Cash + temporary investment held in lieu of cash + current receivable) / current liabilities	
3	Solvency	Total Liability to Net Worth	
Net Profit before Tax			
SN	Period		Value
1	Current period		
2	During the last Financial Year		
3	During the year before last Financial Year		
Financial Arrangements			
SN	Resources		Amount
1	Own		
2	Bank Credits		
3	Others (Specify)		
Sales			
SN	Category of Customers	Value of orders to be executed/ anticipated Sales	
		Current	Next Financial Year
1	Government Department		
2	Commercial		
3	Others		
	Total		
Annual Turnover			
SN	Financial Year (Please begin with current year)		Turnover
1			
2			
3			
4			
5			
6			

**Table 3
Technical Competency**

Classifications		
SN	Category	Please (√)
1	Manufacturer	
2	Clearing & Forwarding Agent	
3	Stockist	
4	Wholesale Dealer	
5	Authorized Reseller	
6	Authorized Service Agent	
7	Retailer	
8	Trader	
9	Others (please specify)	
Details on Plant		
SN	Plant	Details
1	Location	
2	Description	
3	Type	
4	Size of building	
5	Is property on lease or free hold?	
6	If on lease, indicate date of expiry of lease in each case.	
7	Others (please specify)	

Plant Facilities					
SN	Facilities		Ans	Remark	
1	Space available for manufacturing (in m2)				
2	Space available for storage (in m2)				
3	Space available for inspection (in m2)				
4	Are buildings fire resistant? (Y/N)				
5	Are premises approved by Municipal fire Department? (Y/N)				
6	Are buildings under Municipal fire protection?				
7	Are power & fuel supply adequate to meet production requirements? (Y/N)				
8	Are adequate transportation facilities available? (Y/N)				
9	Are safety measures adequate for performance of proposed contract? (Y/N)				
10	Is adequate material handling equipment available? (Y/N)				
Testing Facilities					
SN	Facilities		Details		
1	List testing equipment available				
2	Give details of tests to be carried out on items offered.				
3	Details of the testing organizations available.				
Quality Control Organization					
SN	Quality Control Method		Response		
1	Are goods offered subject to Batch Test, Random Sampling or full 100% test for				
2	Are tests carried out by factory employees or by a separate testing				
3	Are independent Quality Control Organization checks made and				
Manufacturing Capacity					
SN	Description of Equipment	Capacity	Units Manufactured		
			Current year	Last Year	2nd last year
1					

2					
Personnel/ Organization					
SN	Personnel in	Numbers in levels			
		Managerial	Supervisory	Skilled Workmen	
1	Production				
2	Marketing				
3	Installation and commissioning				
4	Service				
5	Spare parts				
6	Administrative				
Service Center nearest to our site location					
Location					
Phone no					
SN	Information required on				Details
1	Number of skilled employees				
2	Number of unskilled employees				
3	Number of engineering employees				
4	Number of administrative employees				
5	List of special repair/ workshop facility available				
6	The storage space available for spare parts (in m2)				
7	Value of minimum stock of spares available at all the service centres in respective currency				
8	List of the models/ types of equipment serviced by the Centre in last 2 years				

References²						
SN	Name of Organization	Address, Telephone, Fax, Contact Person				
1						
2						
List of components usually subcontracted						
1						
2						
Workload for the current and forth coming financial year on quarterly basis						
SN	Financial Year	Quarterly Workload as % of Total Capacity				
		I	II	III	IV	
1	Current Financial Year					
2	Next Financial Year					
List of major projects of similar size and nature previously executed						
S N	Name of the client	Project	Year of award	Year of completion	Capacity/ Products	Value (Curren cy)
1						
2						
3						
4						
Type of equipment manufactured and supplied (M & S) during last 2 years						
SN	Equipment	Capacity	Qty	Projects	On Hand Order Qty	
1						
2						
3						
4						
Type of equipment manufactured, supplied, installed and commissioned (MSIC)						
SN	Equipment	Capacity	Qty	Projects	On Hand Order Qty	
1						
2						
3						
4						

² Names of two buyers to whom similar equipment are supplied, installed and commissioned in the past and to whom reference may be made by the AmulFed Dairy, Gandhinagar regarding the Bidder/Supplier's technical and delivery ability:

Schedules for furnishing technical data and certified drawings after receipt of orders	
1	
2	
Number of weeks required for preparing a bid proposal	